

① [QR code] How to register Credor electronic warranty by smartphone

What to prepare

- Warranty card
- Watch
- Smartphone



① Attaching the QR code sticker

- 1. Peel the QR code sticker off of the QR code sticker tag that came with the purchased watch, and then attach the sticker to the back side of the warranty card.

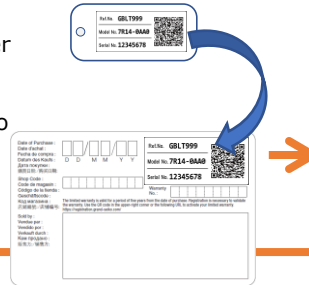

② Entering the date of purchase and shop code and placing shop stamp

- 1. Enter the date of purchase and the shop code.
- 2. Place the shop stamp on the warranty card.



③ Entry page

- Access from the QR code
- 1. Select a language.
- 2. Select your country or region of residence.



④ Entering the shop code and date of purchase

- 1. Enter the shop code written on the warranty card.
- 2. Enter the date of purchase. Note: This is the date written on the warranty card.



⑤ Checking the entered information

- 1. Make sure that there are no mistakes in the entered information.



⑥ Checking the warranty details

- 1. Check the details of the registered warranty and the points to note.
- 2. Enter the warranty number on the back of the warranty card.



⑦ Finishing registration

- 1. A PDF file containing the warranty details will become available for downloading.



②[QR code] How to check the details of your Credor electronic warranty by smartphone

■ What to prepare

○ Warranty card

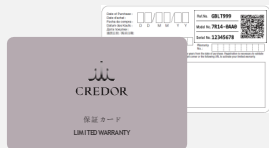

○ Watch



○ Smartphone



① Entering information about the item you purchased

- 1. Access from the QR code
- 2. Touch on the [Check Warranty Details] button.

CREATOR

ENGLISH ▾

Warranty details search

If you want to check your registered warranty details, please enter your watch information into the following required fields.

[Optional] Reference number

Required Model number

Required Serial number

Required Warranty number

FIND YOUR WARRANTY INFORMATION

Warranty registration manual for overseas residents purchased in Japan
https://registration.credor.com/haato_en.pdf

Link to web pages containing Credor instruction manuals:
<https://www.credor.com/sensor/instructions/>

※The model number and serial number are inscribed on the case back of the watch.
 Example 1: Only a number represented as a fraction appears, and the six-digit serial number does not appear.
 ※ Enter the numerator part of the fraction.
 For example, enter the numbers in the numerator of No.000/000.
 Example 2: Both the six-digit serial number and a number represented as a fraction appear.
 ※ Enter the six-digit serial number.

(Regular case back) (See-through case back)

Serial number [ex.] 123456
000000

Model number [ex.] TR14-0AA0

Check Warranty Details

© 2023 Seiko Watch Corporation



② Displaying the warranty details

- 1. The warranty details for the registered watch are displayed.
- 2. A PDF file containing the warranty details will become available for downloading.

CREATOR

ENGLISH ▾

Warranty details

Your registered warranty details are given below.

Warranty number
GSSDAZYVC

Reference number
WIDE400

Model number
W1D1-1WD1

Serial number
100100

Date of purchase
2023/02/21

Shop code
13457

Warranty
Within the warranty period

Should you lose your warranty card, you can use the pdf document of your warranty details as a substitute for the physical warranty card.
 It is recommended that you save the file as a copy.
 Please click the button below to download.

PDF document download was failed.

Download PDF

If you want to perform another search from the warranty details search screen, you can use the following button to go back.

Go Back

[Do you have any trouble with the operation?](#)

© 2023 Seiko Watch Corporation

③ [URL] How to register Credor electronic warranty by PC

■ What to prepare

- Warranty card
- Watch
- Internet-connected PC



① Attaching the QR code sticker

- 1. Peel the QR code sticker off of the QR code sticker tag that came with the purchased watch, and then attach the sticker to the back side of the warranty card.

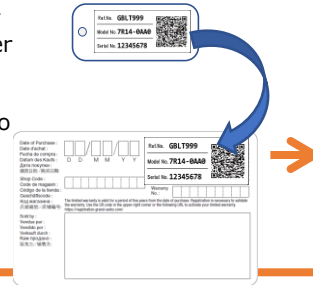

② Entering the date of purchase and shop code and placing shop stamp

- 1. Enter the date of purchase and the shop code.
- 2. Place the shop stamp on the warranty card.



③ Entry page

- Access from a URL on a PC
 1. Select a language.
 2. Select your country or region of residence.



④ Entering information about the purchased item

- 1. Enter information about the purchased item by referring to the warranty card or the case back of the watch.

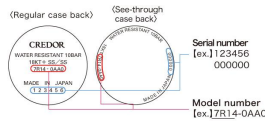

⑤ Entering the shop code and date of purchase

- 1. Enter the shop code written on the warranty card.
- 2. Enter the date of purchase. Note: This is the date written on the warranty card.



⑥ Checking the entered information

- 1. Make sure that there are no mistakes in the entered information.

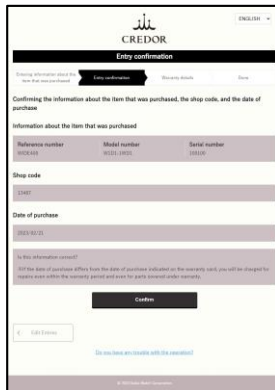

⑧ Checking the warranty details

- 1. Check the details of the registered warranty and the points to note.
- 2. Enter the warranty number on the back of the warranty card.

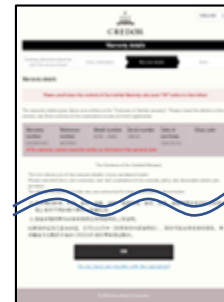

⑨ Finishing registration

- 1. A PDF file containing the warranty details will become available for downloading.

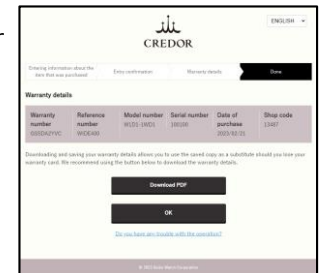

④ [URL] How to check the details of your Credor electronic warranty by PC

■ What to prepare

○ Warranty card



○ Watch



○ Internet-connected PC



① Entering information about the item you purchased

- 1. Access from search URL
- 2. Enter information about the item you purchased by referring to the warranty card or the case back of the watch.

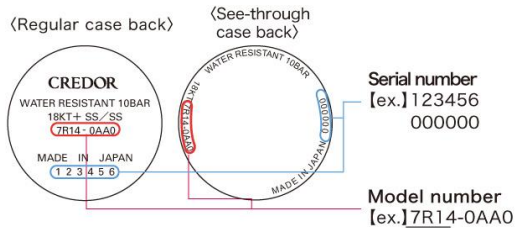

- 3. Click on the [Check Warranty Details] button.

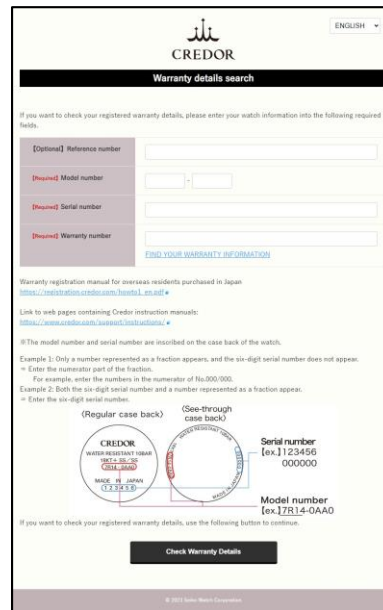

② Displaying the warranty details

- 1. The warranty details for the registered watch are displayed.
- 2. A PDF file containing the warranty details will become available for downloading.

